



# HYDRO-LEK

## REMOTE HANDLING SPECIALISTS



### HLK-RHD5 Manipulator:

The HLK-RHD5 Manipulator is a heavy duty, rugged five-function arm. It incorporates the HLK-2020 Continuous Jaw Rotate Mechanism which also has the unique 19mm diameter rope cutter. The arm incorporates a flange mounting to facilitate port or starboard mounting configurations on the slew plate. The slew plate is designed to enable the arm to swing across the front of the vehicle and also 30° to the outside. The arm also uses the larger HLK-13020 Hydraulic Cylinders to give additional lifting capability.

#### Specification:

<b>Dimensions</b>	<b>Length of arm</b>	<b>943mm</b>
	<b>Length of slew plate</b>	<b>320mm</b>
	<b>Height (Stowed)</b>	<b>515mm</b>
	<b>Width</b>	<b>200mm</b>
<b>Capacities</b>	<b>Rotate</b>	<b>360° continuous</b>
	<b>Torque at 140 bar (across ports)</b>	<b>38Nm</b>
	<b>Lift capacity at full reach at 160 bar</b>	<b>80Kg</b>
	<b>Max working pressure</b>	<b>210 bar</b>
<b>Weight</b>	<b>Weight in air</b>	<b>30Kg</b>
	<b>Weight in water</b>	<b>20Kg</b>
<b>Construction</b>	<b>316 SS Epoxy hard coated</b>	
	<b>HE 30 Hard anodised aluminium</b>	
	<b>High Density Polyethelene</b>	
<b>Ports</b>	<b>1/8NPT / 7/16 S.A.E</b>	

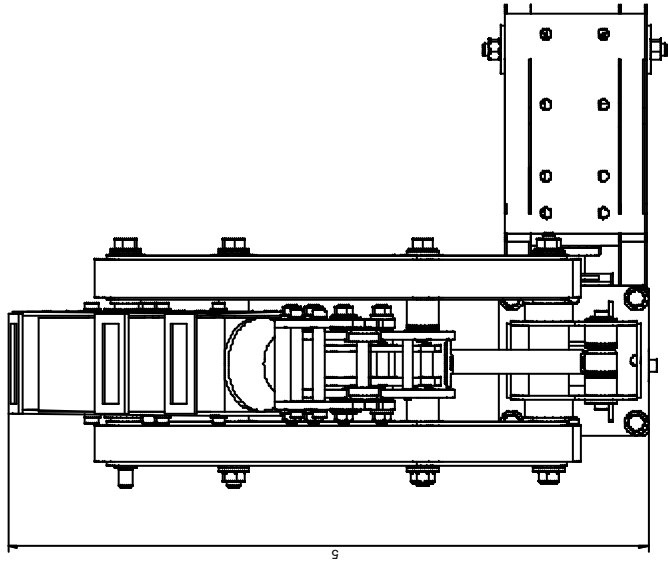
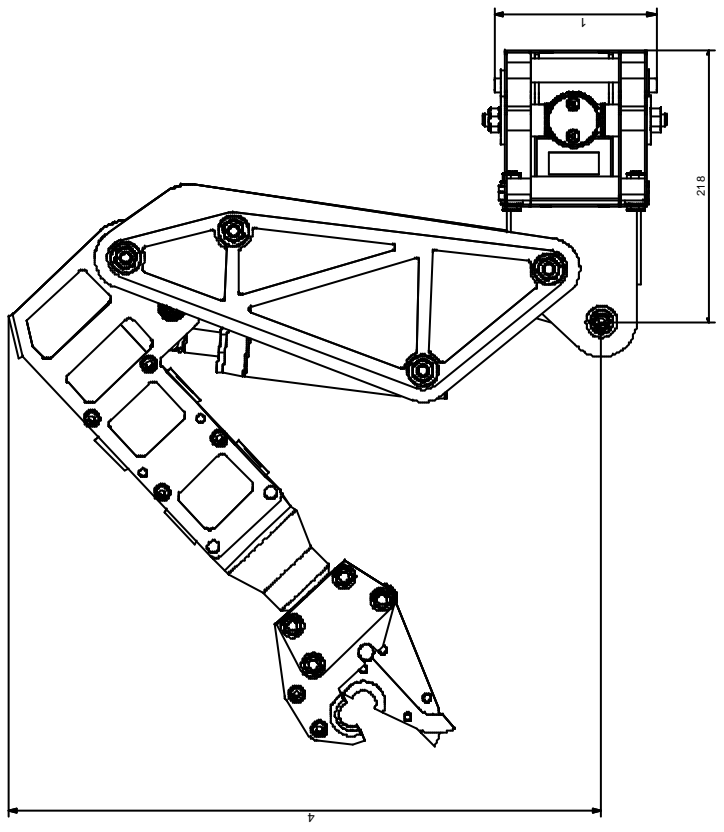
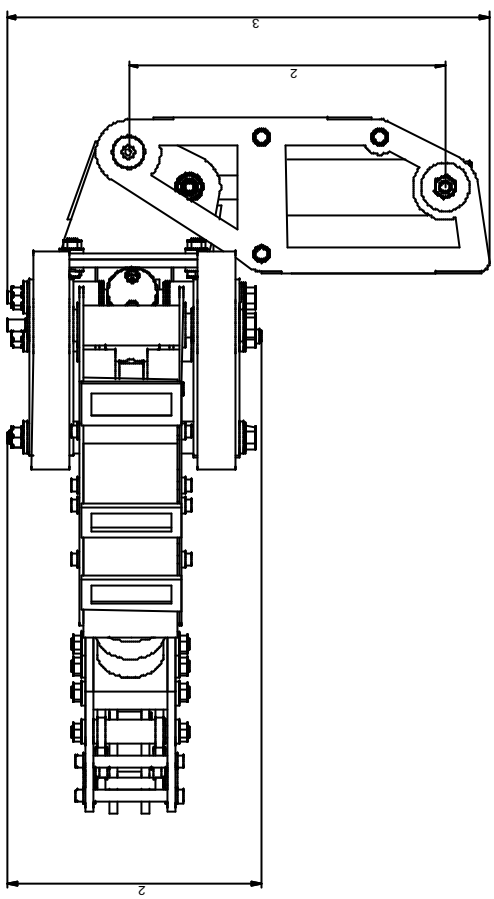

**SPECIFICATION**

LENGTH OF ARM (OPEN) 943 MM (FROM SLEW)

LENGTH OF SLEW PLATE 320 MM

HEIGHT 515 MM

WIDTH 203 MM

CAPACITIES

ROTATE 360° CONTINUOUS

TORQUE AT 140 BAR 38Nm

LIFT CAPACITY AT FULL REACH 80Kg @ 160 BAR

MAX WORKING PRESSURE 210 BAR

WEIGHT IN AIR 30.0 Kg

WEIGHT IN WATER 20.0 Kg

CONSTRUCTION

316 SS EPOXY HARD ANODISED ALUMINIUM

HIGH DENSITY POLYETHYLENE

PORTS:

1/8" NPT / 7/16" SAE